

ISO 9001 Certified Manufacturer



# 20mm Lithium Coin Cell Battery Holders

## Low Profile Surface Mountable

Available on Tape and Reel

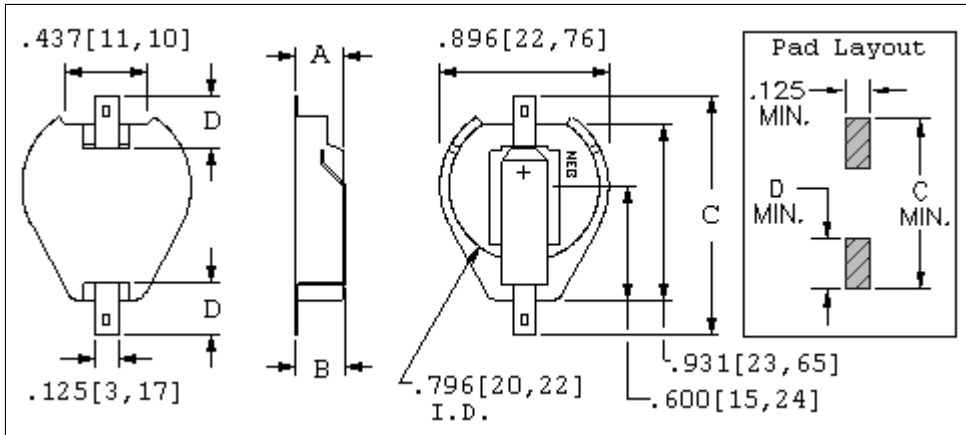

Small Pad Pattern										
Cat. No. (Bulk)		Cat. No. (On Tape*)		Cells	Dims.	A	B	C	D	Battery Reference
Tin Nickel Plate	Gold Flash Plate	Tin Nickel Plate	Gold Flash Plate							
1061	1081	1061TR	1081TR	One	inch [mm]	.256 [6.5]	.286 [7.3]	1.015 [25.8]	.156 [4.0]	CR2016†; DL2016†; CL2020; CR2025; DL2025; BR2032; CR2032
1062	1082	1062TR	1082TR	Two	inch [mm]	.375 [9.5]	.406 [10.3]	1.015 [25.8]	.156 [4.0]	
<p><b>Contact Material:</b> .015" [0.38mm] Spring Steel</p> <p><b>Base:</b> High Temperature Nylon-46</p> <p><b>Operating Temp. Range:</b> -60°F TO +293°F (-50°C TO +145°C)</p> <p>* <b>Tape And Reel Spec's:</b> 44mm wide; 32mm pitch; 13" reel (200 pieces per reel) All conductive polystyrene carrier tape meets ANSI/EIA - 481 standard.</p>										
†Cat. No. 1081 (1 or 2 Cells); Cat. No. 1082 (3 cells)										

Large Pad Pattern										
Cat. No. (Bulk)		Cat. No. (On Tape*)		Cells	Dims.	A	B	C	D	Battery Reference

Tin Nickel Plate	Gold Flash Plate	Tin Nickel Plate	Gold Flash Plate							
<b>1063</b>	<b>1093</b>	<b>1063TR</b>	<b>1093TR</b>	One	inch [mm]	.256 [6.5]	.286 [7.3]	1.250 [31.7]	.278 [7.0]	CR2016†; DL2016†; CL2020; CR2025 DL2025; BR2032; CR2032
<b>1064</b>	<b>1094</b>	<b>1064TR</b>	<b>1094TR</b>	Two	inch [mm]	.375 [9.5]	.406 [10.3]	1.250 [31.7]	.278 [7.0]	
<b>Contact Material:</b> .015" [0.38mm] Spring Steel										
<b>Base: High Temperature Nylon-46</b>										
<b>Operating Temp. Range: -60°F TO +293°F (-50°C TO +145°C)</b>										
* <b>Tape And Reel Spec's:</b> 44mm wide; 32mm pitch; 13" reel (200 pieces per reel) All conductive polystyrene carrier tape meets ANSI/EIA - 481 standard.										
†Cat. No. 1093 (1 or 2 Cells); Cat. No. 1094 (3 cells)										

[Click to Request Samples](#)

[VIEW PRODUCT OVERVIEW](#)